

CARE & MAINTENANCE >>

1. ▲WARNING. Check the Bolts, Rivets, brakes and accessories very carefully before using this stroller.
2. ▲WARNING. Stop using this product if there is any damage or broken parts or pieces.
3. Lubricate all moving parts and joints with a penetrating spray lubricant, from time to time.
4. Remove front wheel cylinder housings and clean thoroughly from time to time.
5. Clean the stroller frame by wiping with moist cloth and dry thoroughly to prevent any rusting.
6. Always wipe dry your stroller after using it in the rain or in winter climates, making sure road salt is removed from frame and joints. Allow the stroller to stand in an open, warm and ventilated place to dry.
7. Do not leave your stroller outside in wet weather as the fabric could mildew.
8. Only hand-wash the fabric by using mild detergent in warm water. DO NOT wash in machine. Hang in a ventilated place to dry. DO NOT tumble dry.
9. If you have any questions regarding the product please contact guzzie and Guss at 1-888-597-0992, or online at www.guzzieandguss.com. We will provide you the best customer service.
10. It may be unsafe to use accessories other than those approved by the manufacturer or distributor.
11. It may be unsafe to use replacement parts other than those supplied or approved by the manufacturer or distributor.

PRODUCT REGISTRATION AND WARRANTY >>

The G+G 101 Goose stroller has a Limited Warranty for the period of 1 year from the receipt of purchase against manufacturers' defects and workmanship.

For Registration: submit online @ www.guzzieandguss.com
Or mail to the address provided.

Contact Info:
Peter John M. Distribution Inc.
88 SW Marine Drive, Vancouver, BC
Canada V5X 2R1
www.pjmdistribution.com
CANADA: 1-888-597-0992
Fax 1-604-324-2876

G+G101 Goose
Instruction Manual

guzzie+GUSS®

G+G101 Goose Stroller



Please read this instruction manual carefully before using this product.
Be sure to save these instructions for future reference.

INTRODUCTION >>

guzzie+Guss are committed to making the lives of children and parents safe, uncomplicated and convenient. We would like to thank you for purchasing this exciting product. It is important that you read and follow the instructions in this manual carefully. Please make sure all the parts are properly attached and the removable pieces fit on correctly. Please pay close attention to the opening and closing mechanism. Read all warnings and safety steps before use.

IMPORTANT >>

After completely reading and following all instructions in this manual, please file the instruction manual in a safe place for future reference. If the product you have received operates differently from instructions included with the product please contact guzzie+Guss on the internet at info@guzzieandguss.com. There you can obtain the most current information regarding your new G+G 101 Goose stroller. You may have to provide the registration number and manufacturing date; this information will be found on frame of your stroller.

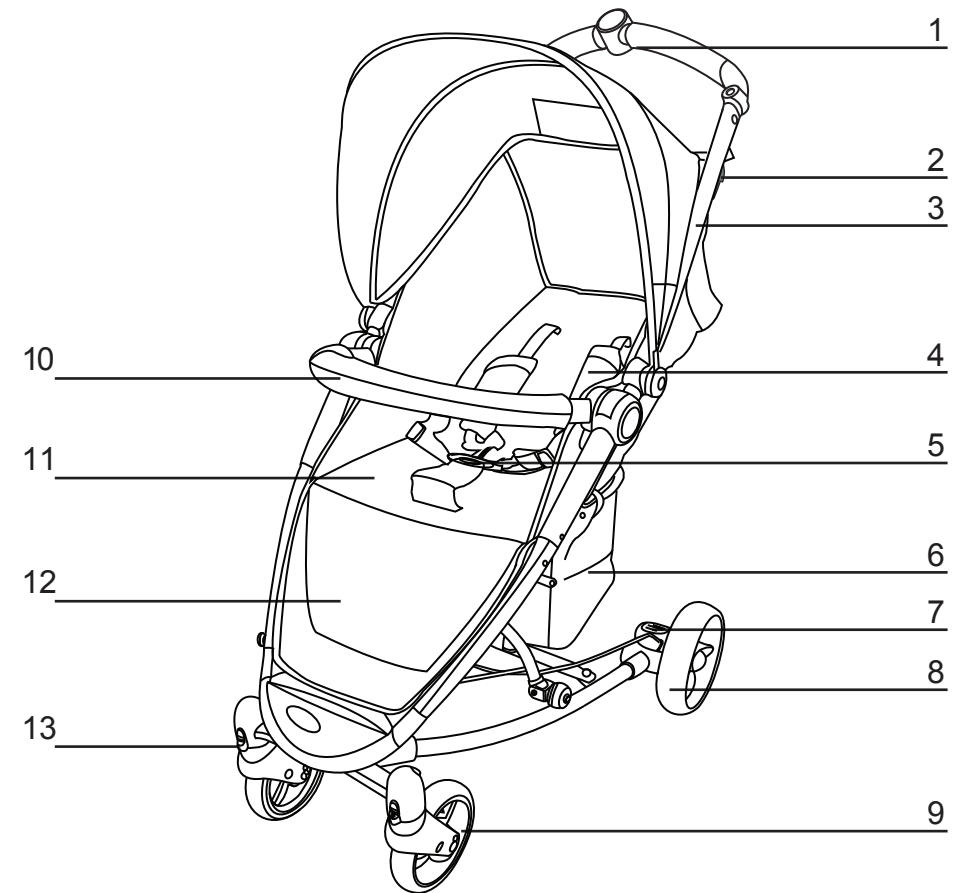

- | | | |
|----------------------|-----------------|----------------|
| 1 Button | 6 Mesh basket | 11 Seat |
| 2 Folding latch | 7 Parking brake | 12 Foot Rest |
| 3 Handle | 8 Rear wheel | 13 Swivel lock |
| 4 Shoulder protector | 9 Front wheel | |
| 5 Harness buckle | 10 Front bar | |

WARNINGS >>

- ▲ Read and understand these instructions before using this product.
- ▲ Never leave child in the stroller unattended.
- ▲ To ensure proper use, store this user guide in a convenient place so it can be consulted often. Failure to follow all warnings and instructions could result in serious injury or death.
- ▲ **WARNING!** Care must be taken when folding and unfolding the product to prevent finger entrapment.
- ▲ This stroller is designed for one child.
- ▲ Make sure child's arms are clear when adjusting the seat – backrest up or down.
- ▲ Avoid serious injury from falling or sliding out. Always use the 5-point harness to secure child.
- ▲ Do not use stroller with a child who weighs more than 50 lbs (22kgs).
- ▲ Do not use stroller with a child taller than 40 inches (101.6 cm).
- ▲ Do not overload basket – Maximum weight in basket is 10 lbs (4.5kg). Overloading the basket may cause the stroller to become unstable.
- ▲ Always make certain that the stroller is fully opened and in the locked position before use.
- ▲ Assembly of this stroller must be performed only by an adult.
- ▲ Do not hang or place items on the stroller handle or frame except for those approved by guzzie+Guss. They may cause the stroller to become unstable.
- ▲ Do not allow children to climb on or play with the stroller.
- ▲ Never use stroller on stairs or escalators
- ▲ **WARNING.** Never allow the child to stand while in the stroller.
- ▲ To avoid entrapment or pinching, do not fold or unfold stroller when child is in or within reach of the stroller.
- ▲ Only use this stroller on even surfaces such as sidewalks and roads, and at walking speed.
- ▲ Stroller is intended for walking speed only. Do not use while jogging, skating, etc.
- ▲ Always set the parking brake when stroller is not moving.
- ▲ Only use accessories and replacement parts approved by guzzie+Guss
- ▲ Do not use this stroller if there are any broken or missing parts.
- ▲ When the stroller is not being used, please store the stroller in the dry and shady place.
- ▲ The stroller is not a toy; do not let children play with the stroller.

STROLLER CONTENTS >>

- a. The Stroller chassis, including the seat upholstery fabric attached, and a storage basket attached.
- b. The Canopy/Hood and back drape
- c. The Wheels, 2 fronts & 2 rears
- d. Car seat hooks (2) and Manual

Attaching the wheels to the chassis:

NOTE: You should lubricate the wheels prior to installing them. Use oil based lubricant, and make sure to lubricate the shaft as well as the wheels on the axle. Make sure to remove any excess lubricant with a cloth or paper towel.

a. To install the front wheels, lay the stroller on it's back with the rear wheels on the bottom against the floor. There is no right or left, either set will fit properly on both sides.

b. Slide a washer, onto the wheel post. Then slide the front wheel post into the front wheel housing of the stroller chassis. Push the wheel up until it clicks into place. Repeat the same procedure on the other side.

c. To remove the front wheel, look for a release button at the top of the wheel housing cylinder. While pushing the button, slide the wheel housing cylinder off the post.

To assemble rear wheels: Insert rear wheel pegs into plastic houses until a click is heard. To remove the rear wheel; press down on the latch located on the plastic housing. Pull the rear wheel out.

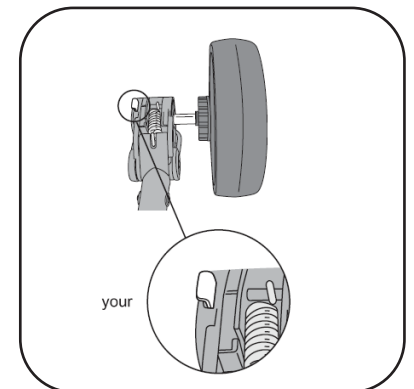
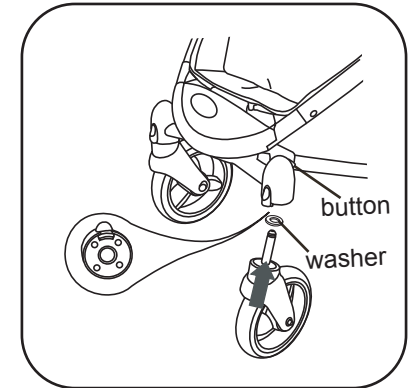

Getting Started (Assembling the Stroller)

IMPORTANT: Before beginning to assemble the stroller, be sure that you have all proper parts and pieces for your stroller and that these parts and pieces are in proper working condition.

1. Opening the chassis: Figure 1
To unfold frame: First undo the frame lock, located on the right side of the frame. Then grasp the handle and lift up quickly to open frame. Once upright, press down handle until a click is heard. See Figure 1.

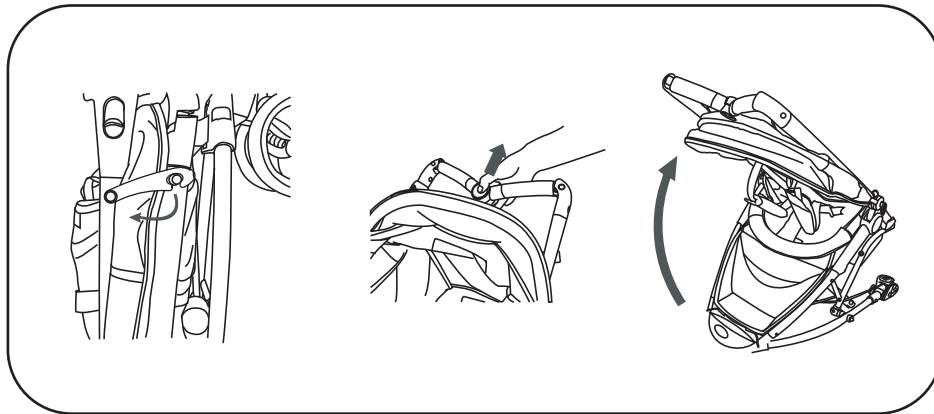

USING YOUR STROLLER >>

Attaching the Canopy/Hood:

1. To assemble the canopy: Align the holes on the canopy fixture with the fixing rivets on the handles. Press the fixture onto the handles. Snap on the buttons as shown in Figures 4B and 4C.
2. On the back of the canopy flap, you will find a strip of vecro, this will attach to the back of the seat top.

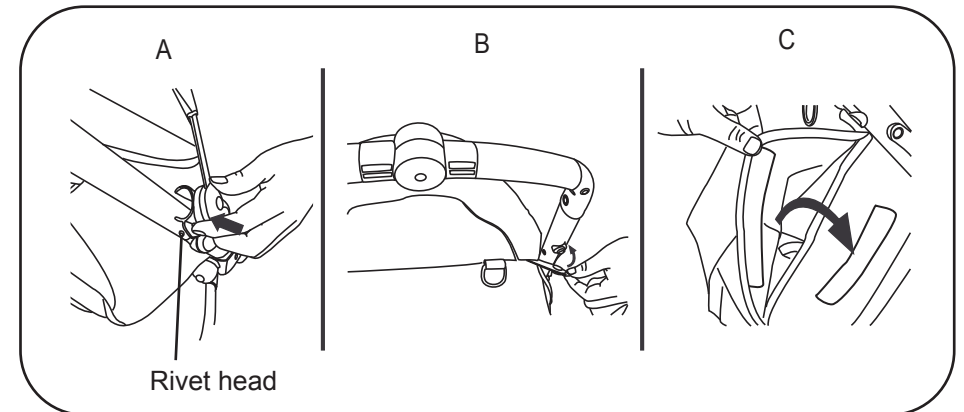

To Remove Canopy

Twists the "C" clamps until they pop off the stroller frame, and undo the Velcro from the back of the seat fabric.

Using the Canopy

To adjust the canopy: Pull forward or press back on the canopy to open or close the canopy. The fold out visor can be pulled out for extra shading from the sun.

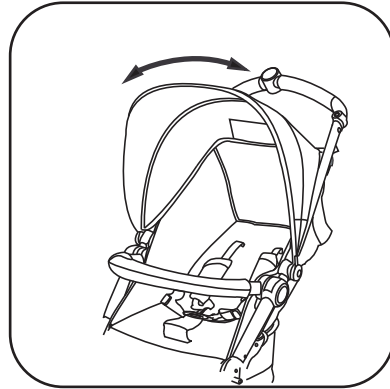

To assemble the front bar

Insert the front bar pegs into holes in the base until they click. To remove, press down side buttons and remove completely. See Figure 5.

The guzzie+Guss G+G101 Goose stroller has been equipped with a foldout visor on the front of the canopy; you can either pull this out, or tuck it back into the canopy to store it.

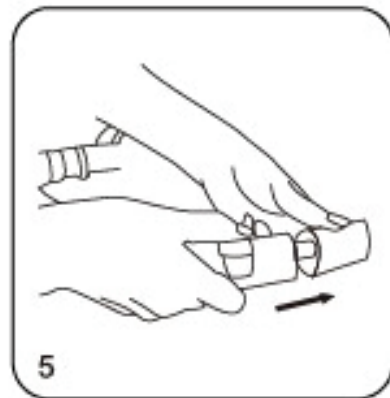
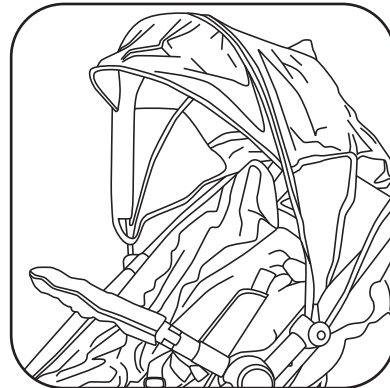

Using Your Stroller:

1. To use the safety harness:
 - A five point harness is provided to secure your child in the stroller.
 - All straps of the harness are adjustable by moving the slider on each strap.
 - The buckle is released by squeezing the buckle tongues together.
 - The harness must be used at all times and adjusted for a comfortable fit.

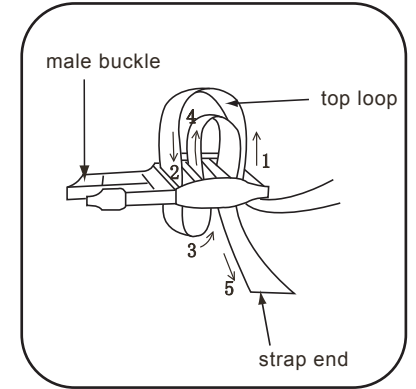

To adjust waist length: To shorten, pull bottom loop (2) down then pull on strap end (1). To lengthen, pull out top loop (3) then pull out on buckle. See figure 6.

Reclining the Stroller Seat-backrest:

- a. To recline (lower) the seat, press down on the grey button and pull back the seat.
- b. To erect (raise) the seat-backrest; hold the adjusting buckle (A), and pull up on the plastic ring which is attached to the end of the adjusting webbing.

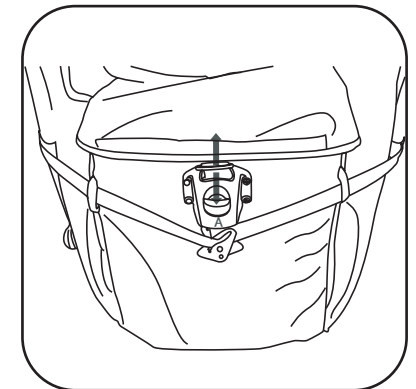

Pushing the stroller

The front swiveling wheels can be locked into a stationary position (so they will not swivel). You will find on the top of both front wheel housings a black button. Push to engage the locking mechanism.

To release the swivel lock, slide the tab up, repeat on both sides.

To use braking system:

Step down on rear wheel parking brake lever 1 (red) to brake. Step down on rear wheel parking brake lever 2 (grey) to release brake. Always apply the wheel brakes whenever you are stopped.

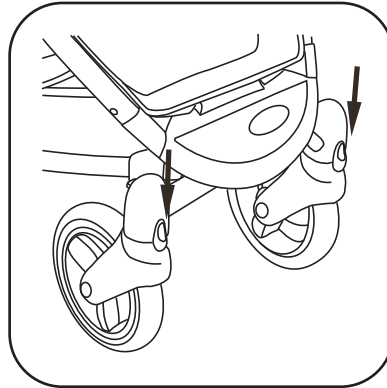

Brake System Adjustment Instruction

Caution: Always check and adjust the brake cable to make both brakes work correctly. Do not overstep brake pedal. Follow the instructions below to adjust brake system:

1. Twist the adjustment nut to right side to tighten brake pedals.
2. Twist the adjustment nut to left side to loosen the brake pedals.
3. After twisting the adjustment nut into the correct position, tighten the fixing nut into place to secure the adjustment nut.

Folding the stroller:

- (A) Press down button on Handle and push downward on the Handle (1).
- (B) Release the folding latches (4) on the handles and push forward the handles at the same time
- (C) Continue to push down towards the front wheels to completely fold the frame. Be sure to secure the frame lock once the stroller has been folded.

Warning: make sure children are not close to the stroller while you fold the stroller.

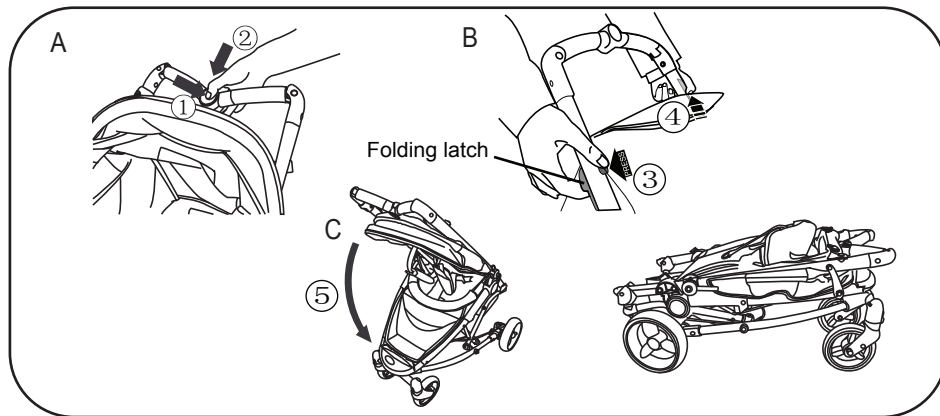

Attaching and detaching A carseat from the stroller:

Please note: at time of production, this stroller is only capable of working with Graco SnugRide brand car seats, other car seats may not work or fit with this stroller.

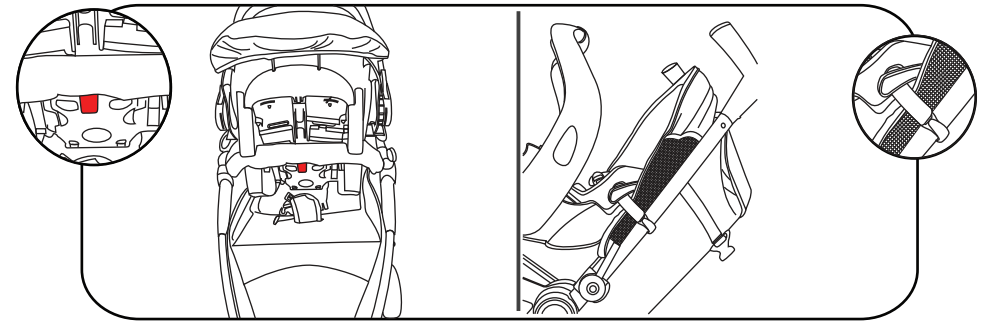

To attach a car seat to the stroller:

1. Remove the fabric cover from the front bar.
2. Insert the car seat into the stroller seat with the car seat facing back towards the handlebar and seatback.
3. Align the red hook on the back of the car seat with the corresponding holes on the front bar of the stroller and press down until you hear a click. Please make sure that the red hook has fully locked onto the front bar of the stroller before use with your baby.
4. Hook the round plastic hooks of the car seat straps onto the stroller handles. Clip the other plastic ends into the seatbelt slots on the car seat. See Figure 6.

ACCESSORIES >>

Available guzzie+Guss accessories
(sold separately)

Universal Cup Holder

Universal Rain Cover

Universal Hitch

